

30th Annual Animal Behavior Conference

Indiana University Bloomington
March 31 – April 1, 2023



Artwork created by AI

Keynote Speaker

Dr. Justin N. Wood
Indiana University

“Using video games to reverse engineer
animal intelligence”

Plenary Speaker

Dr. Vanessa Ezenwa
Yale University

“In sickness and in health: complex
effects of social behavior on infectious
disease”

PROGRAM CONTENTS

PROGRAM IN BRIEF	2
WI-FI ACCESS AND CONVENTION CENTER ACCOMMODATIONS.....	3
INFORMATION FOR PRESENTERS.....	3
MONROE CONVENTION CENTER AND PARKING	4
PROGRAM SCHEDULE	
Friday talks.....	6
Saturday talks	10
Poster presentations	13
BIOGRAPHIES	
Plenary and Keynote speakers	19
ACKNOWLEDGEMENTS	20

*Please see the conference website for abstracts of all talks and poster presentations:
<https://animalbehavior.indiana.edu/news-events/conference/schedule.html>*

**This is a public event where pictures will be taken, and you may be photographed during the conference.*



Please recycle your lanyards and badge holders at the end of the conference in the designated basket.

PROGRAM IN BRIEF

FRIDAY, MARCH 31ST

TALKS

9:30 AM – 5:00 PM

Duke Energy Room West, Monroe Convention Center

STUDENT SOCIAL

5:00 PM – 6:00 PM

Duke Energy Room East, Monroe Convention Center

POSTER SESSION

7:00 – 9:00 PM

Cook and Zebendon Rooms, Monroe Convention Center

SATURDAY, APRIL 1ST

TALKS

10:00 AM – 5:00 PM

Duke Energy Room West, Monroe Convention Center

CAREER PANEL

1:00 PM – 2:00 PM

Duke Energy Room West, Monroe Convention Center

CLOSING RECEPTION

5:15 PM – 6:45 PM

1st Floor Lobby, Monroe Convention Center

HOW TO DONATE TO CISAB

Registration for the IU Animal Behavior Conference is free. However, funding for the meeting depends on contributions from generous donors. Please consider donating to CISAB's Foundation account to help support this and future meetings.

Suggested Donation: Students - \$10; Faculty - \$30

Donate at www.myiu.org/one-time-gift

Type 'ANIMAL' in the Search Box to find "Program in Animal Behavior"

WI-FI ACCESS

MONROE CONVENTION CENTER:	Wi-Fi network: MCCC Guest WiFi No password is required <i>For assistance, see Convention Center staff or call 812-336-3681</i>
INDIANA UNIVERSITY CAMPUS:	Wi-Fi network: attwifi No password is required, but you may need to restart your browser <i>For assistance, contact the IMU front desk at 812-856-6381</i>

ACCOMMODATIONS FOR NURSING MOTHERS

At the Convention Center, nursing mothers will be provided with a private office, electricity, and a refrigerator, if needed. Please see Convention Center staff at the front desk or call 812-336-3681.

INFORMATION FOR PRESENTERS

INSTRUCTIONS FOR UPLOADING TALKS REMOTELY:

*Submit your presentation **no later than 48 hours** before your presentation time.*

Name your presentation file as follows:

PresentationDay_PresentationTime_LastName_FirstName_OperatingSystem.FileExtension.

For example: Fri_1100AM_Doe_John_Mac.pptx

Audio and video can be included in the PowerPoint presentations.

Additionally, any supplementary audio or video files can be submitted in a zipped file. Use the file name above and add “_Suppl” to the end of the file name. For example: Fri_1100AM_Doe_John_Mac_Suppl.zip

After you have named your file(s) appropriately, email them to: aguilare@iu.edu

You will receive a confirmation message indicating that your files have been received.

To make updates to a submitted presentation, repeat this process with the same filename. We will use the most recent version of the file.

DAY OF PRESENTATION:

Please report to the speaker ready table 10 minutes before your talk to be fit with a microphone. This table will be located in the back of the presentation hall.

INSTRUCTIONS FOR POSTER SET-UP:

Posters can be set up in the Cook and Zebendon Rooms any time after 1:00 PM on Friday, March 31st. You will receive your poster number, instructions for where to hang your poster, and hanging materials upon arrival.

INSTRUCTIONS FOR POSTER TAKE-DOWN:

Please take your poster with you at the end of the poster session at 9:00 PM on Friday, March 31st.

MONROE CONVENTION CENTER

302 S. College Avenue
Bloomington, IN 47403

Phone: 812-336-3681
www.BloomingtonConvention.com

FIRST FLOOR

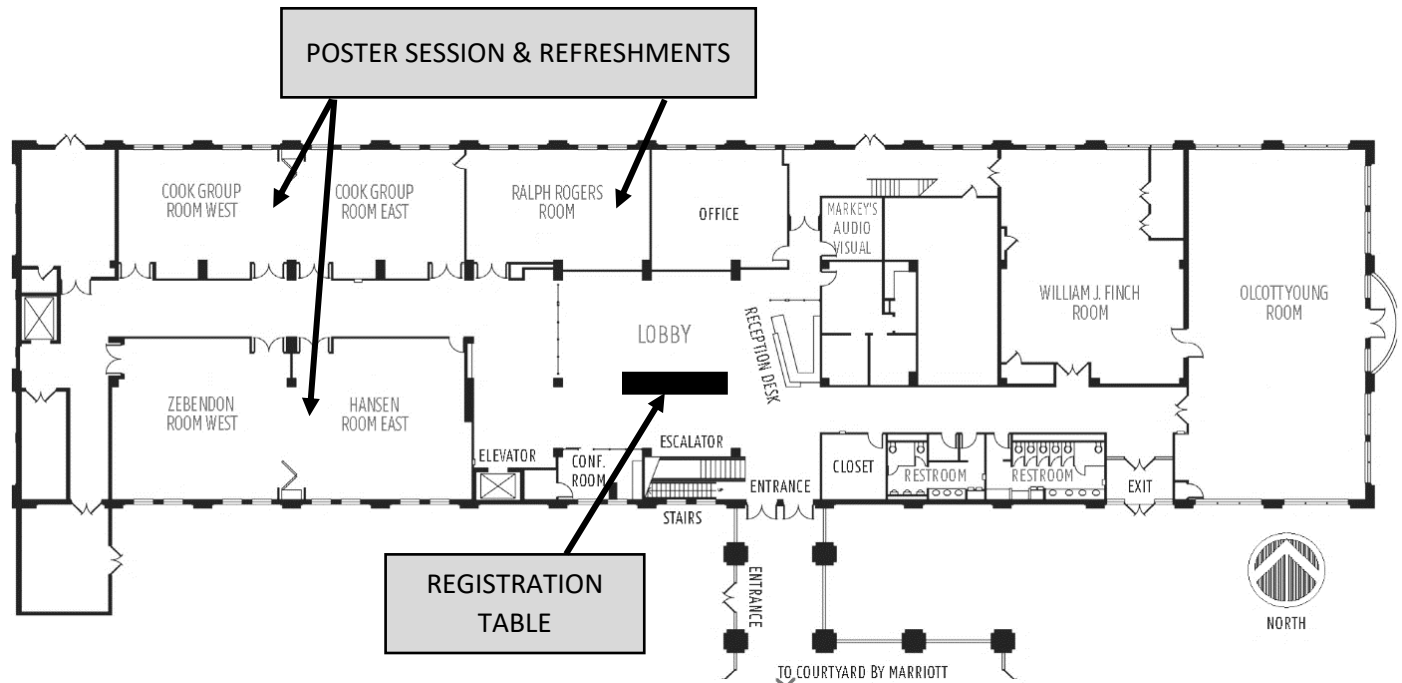

SECOND FLOOR

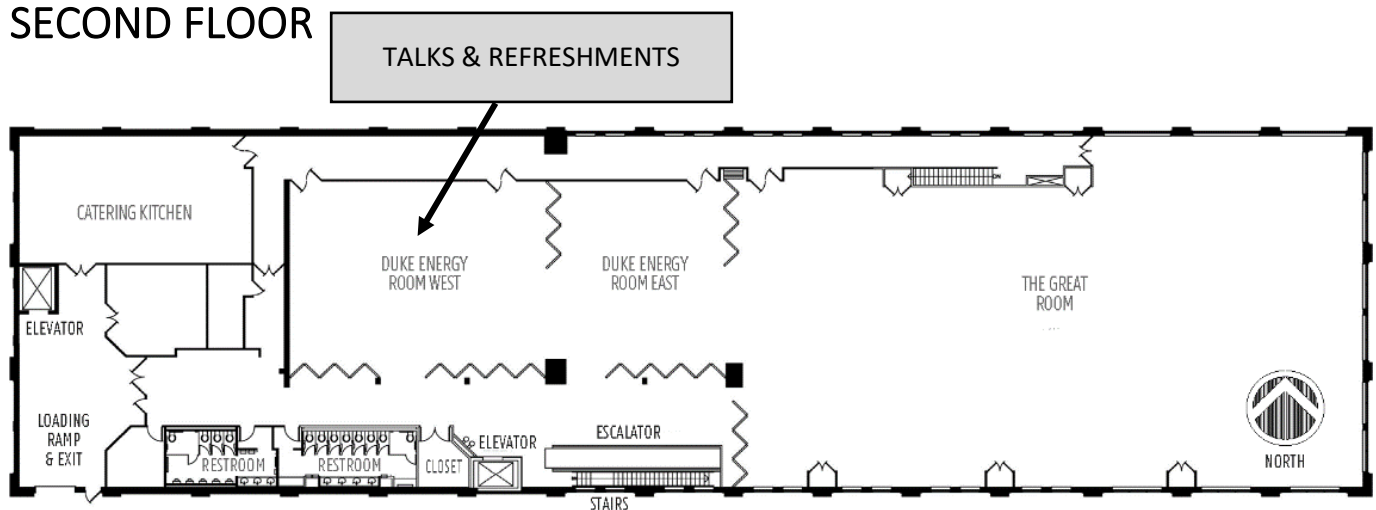

FREE PARKING AT CONVENTION CENTER

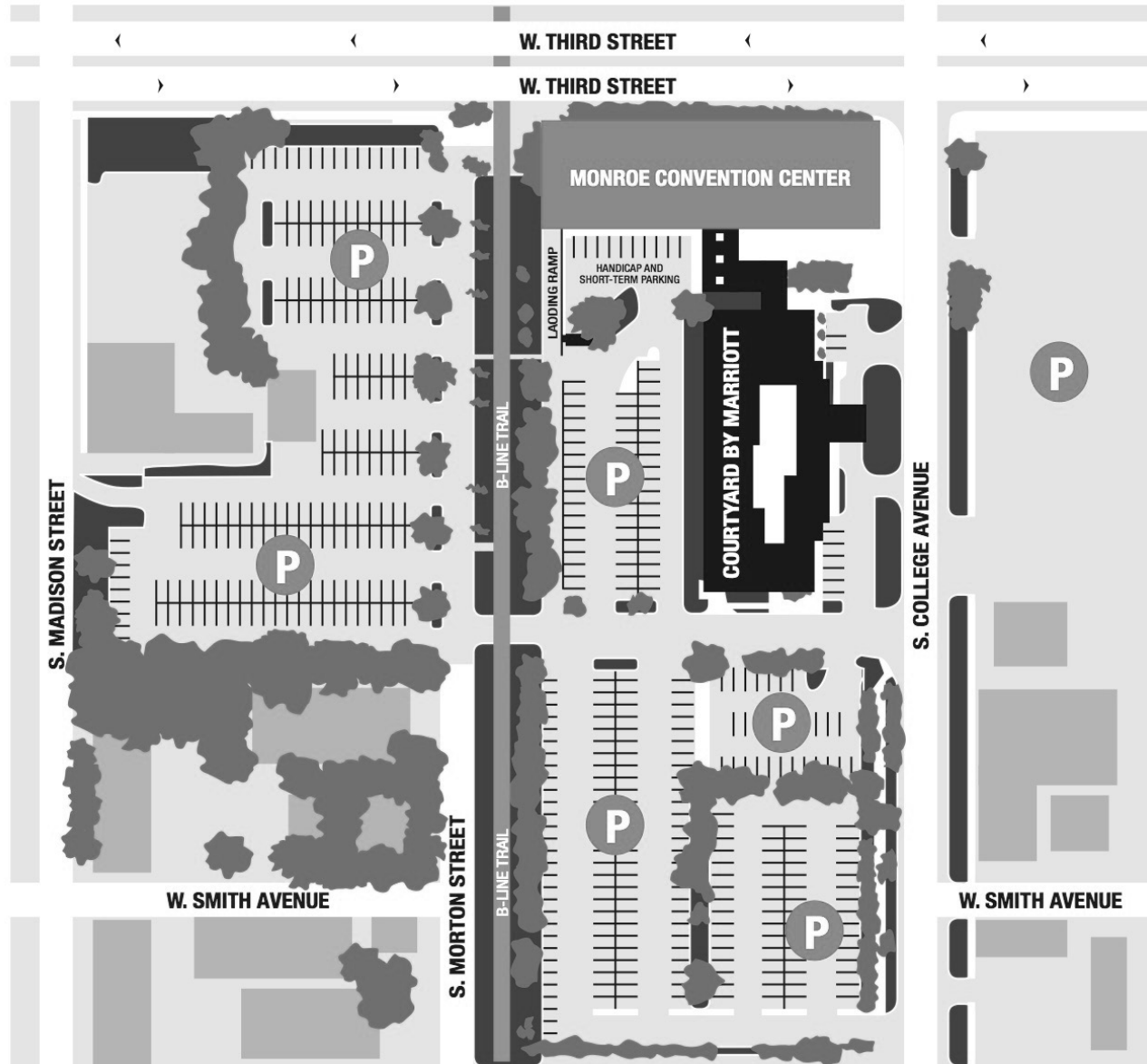

For updated links for transportation around Bloomington, please see the Accommodations page of the Animal Behavior Conference section on the CISAB website:

<https://animalbehavior.indiana.edu/news-events/conference/accomodations.html>.



FRIDAY, MARCH 31ST

SCHEDULE OF TALKS

DUKE ENERGY ROOM WEST, MONROE CONVENTION CENTER

Abstracts with complete author lists are available on the conference website:

<https://animalbehavior.indiana.edu/news-events/conference/schedule.html>

9:30 – 9:45 **Welcoming Remarks (coffee and continental breakfast available)**
Cara L. Wellman, Director, Center for the Integrative Study of Animal Behavior

SESSION I **COMMUNICATION**

9:45 – 10:00 **LET'S GET PHYSICAL: PHYSICAL ENRICHMENT ALTERS MALE MOUSE RESPONSE TO COURTSHIP REJECTION VOCALIZATIONS**

Lauren R. Brunner

Graduate Student, Department of Biology, Indiana University

10:00 – 10:15 **IT'S ALL GREEK TO ME: CULTURALLY DIVERGENT SONGS AS A MECHANISM FOR POPULATION DIVERGENCE IN NUTTALL'S WHITE-CROWNED SPARROWS (*ZONOTRICHIA LEUCOPHRYS NUTTALLI*)**

Amy R. Luo

Graduate Student, Department of Ecology and Evolutionary Biology, University of Tennessee – Knoxville

10:15 – 10:30 **COMMUNICATIVE ANTECEDENTS TO HELPING BEHAVIOR IN RATS**

Caroline Driscoll-Braden

Graduate Student, Department of Biology, University of Louisville

10:30 – 10:45 **ARE YOU LISTENING? URBAN LIVING IMPACTS AUDITORY PROCESSING IN A CITY-DWELLING SONGBIRD**

Linda Nduwimana

Undergraduate Student, Department of Biology, Hope College

10:45 – 11:00 **ECOLOGY AND BEHAVIOR PREDICT AN EVOLUTIONARY TRADE-OFF BETWEEN SONG COMPLEXITY AND ELABORATE PLUMAGES IN ANTWRENS (AVES, THAMNOPHILIDAE)**

Renata Beco

Graduate Student, Department of Ecology and Evolutionary Biology, University of Tennessee – Knoxville

REFRESHMENT BREAK

SESSION II **STRESS I: PHYSIOLOGY**

11:15 – 11:30 **STRESS RESPONSIVE GROOMING IN F344 RATS**

Anthony Glorius

Graduate Student, Department of Pharmacology and Systems Biology, University of Cincinnati

11:30 – 11:45 **STARTLE RESPONSE AND CORTICOSTERONE IN NEOTROPICAL TADPOLES**

Lisa L. Surber

Graduate Student, Department of Evolution, Ecology, and Behavior, University of Illinois Urbana-Champaign

11:45 – 12:00 **DEPLETION OF GLUCOCORTICOID RECEPTORS IN PREFRONTAL CORTEX PYRAMIDAL NEURONS MITIGATES STRESS-INDUCED SYNAPTIC AND BEHAVIORAL DEFICITS**

David T. Dadosky

Graduate Student, Department of Pharmacology and Systems Biology, University of Cincinnati

LUNCH BREAK

SESSION III **PARENTAL AND SOCIAL BEHAVIOR**

1:45 – 2:00 **EXPERIMENTAL MANIPULATIONS OF OFFSPRING FOOD AVAILABILITY SUGGEST BEGGING CONTAINS LITTLE INFORMATION IN A FROG WITH FACULTATIVE PARENTAL CARE**

Olivia L. Brooks

Graduate Student, School of Biological Sciences, Illinois State University

2:00 – 2:15 **INTERINDIVIDUAL VARIATION IN ADOLESCENT FEMALE-INFANT INTERACTIONS: PRELIMINARY DATA FROM THE AMBOSELI BABOONS**

Chelsea A. Southworth

Graduate Student, Department of Biological Sciences, University of Notre Dame

2:15 – 2:30 **DISENTANGLING DECISION RULES UNDERLYING FLEXIBLE SEX-REVERSAL OF PARENTAL CARE IN A POISON FROG**

Jeanette B. Moss

Postdoctoral Fellow, Department of Evolution, Ecology, and Behavior, University of Illinois Urbana-Champaign

REFRESHMENT BREAK

SESSION IV **STRESS II: EARLY LIFE STRESS**

2:45 – 3:00 **ADOLESCENT AND ADULT RATS DIFFER IN EXPRESSION OF ACUTE EARLY LIFE STRESS-ENHANCED FEAR LEARNING**

Brianna L. Minshall

Graduate Student, Department of Psychology, Miami University

3:00 – 3:15 **RESOURCE SCARCITY ALTERS ADDICTION-RELATED BEHAVIORS AND THE BASOLATERAL AMYGDALA TRANSCRIPTOME IN SEX-SPECIFIC WAYS**

Amelia Cuarenta

Postdoctoral Fellow, Center for Behavioral Neuroscience, Georgia State University

3:15 – 3:30 **EARLY POSTNATAL HEAT AND THE POTENTIAL FOR CARRYOVER EFFECTS IN GENE EXPRESSION IN TREE SWALLOW NESTLINGS (*TACHYGINETA BICOLOR*)**

Melissa R. Proffitt

Postdoctoral Fellow, National Institute for Mathematical and Biological Synthesis, University of Tennessee – Knoxville

3:30 – 3:45 **PERINATAL OPIOID EXPOSURE LEADS TO DECREASED SOCIAL PLAY IN ADOLESCENT MALE AND FEMALE RATS**

Hannah J. Harder

Graduate Student, Center for Behavioral Neuroscience, Georgia State University

REFRESHMENT BREAK

4:00 – 5:00 **KEYNOTE SEMINAR:**

USING VIDEO GAMES TO REVERSE ENGINEER ANIMAL INTELLIGENCE

Justin N. Wood

Associate Professor, Department of Informatics, Indiana University

STUDENT SOCIAL

This casual event is open to anyone interested. Several grad students from different years, labs, and programs will introduce their studies and experiences as grad students at Indiana University. Then, a Q&A session will follow. Ice cream will be provided as well.

5:00 – 6:00 PM

Duke Energy Room West, Monroe Convention Center

POSTER PRESENTATIONS

Please reconvene this evening for our annual poster session.

7:00 – 9:00 PM

Cook and Zebendon Rooms, Monroe Convention Center

Hors d'oeuvres will be served in the adjacent Ralph Rogers Room

See pages 13-18 for list of posters.

Poster abstracts are available on the conference website:

<https://animalbehavior.indiana.edu/news-events/conference/schedule.html>

Presenters who wish to upload a PDF of their poster to a shared OneDrive folder for online viewing may do so at:

<https://tinyurl.com/ABC2023PosterUploads>

(Enter the password: AnimalBehavior2023)

SATURDAY, APRIL 1ST

SCHEDULE OF TALKS

DUKE ENERGY ROOM WEST, MONROE CONVENTION CENTER

Abstracts with complete author lists are available on the conference website:

<https://animalbehavior.indiana.edu/news-events/conference/schedule.html>

10:00 – 10:15 **Welcoming Remarks (coffee and continental breakfast available)**
Cara L. Wellman, Director, Center for the Integrative Study of Animal Behavior

SESSION V **EVOLUTION AND HUMAN IMPACTS ON BEHAVIOR**

10:15 – 10:30 **WITH FRIENDS LIKE THESE: A GLOBAL SYNTHESIS OF DISTURBANCE-BASED FORAGING ASSOCIATIONS OF BIRDS**
Jonah S. Dominguez
Graduate Student, Department of Evolution, Ecology, and Behavior, University of Illinois Urbana-Champaign

10:30 – 10:45 **CRITICAL FACTORS INFLUENCING BOBCAT RECOVERY IN EAST-CENTRAL OHIO**
Xinzhu Zhang
Graduate Student, Department of Evolution, Ecology, and Organismal Biology, The Ohio State University

10:45 – 11:00 **HOUSE SPARROW (*PASSER DOMESTICUS*) AND HOUSE FINCH (*HAEMORHOUS MEXICANUS*) SIGNAL TRANSMISSION VARIES ACROSS AN URBANIZATION GRADIENT**
Sarah E. Grimes
Undergraduate Student, Department of Biology, Hope College

11:00 – 11:15 **NEST ARCHITECTURE INFLUENCES HOST USE BY AVIAN BROOD PARASITES AND IS SHAPED BY COEVOLUTIONARY DYNAMICS**
Mark E. Hauber
Faculty, Department of Evolution, Ecology, and Behavior, University of Illinois Urbana-Champaign

REFRESHMENT BREAK

SESSION VI **HORMONES AND PHYSIOLOGY**

11:30 – 11:45 **THE EFFECTS OF PUBERTAL ONSET ON BEHAVIORS MEDIATED BY THE DOPAMINE SYSTEM IN LONG EVANS RATS**
Victoria R. Riesgo
Graduate Student, Department of Psychology, Bowling Green State University

- 11:45 – 12:00 **INDIVIDUAL CONDITION AND STEROID LEVELS COVARY WITH SOCIALITY AND CONTEXT IN ELECTRIC KNIFEFISHES**
Megan K. Freiler
Graduate Student, Department of Biology, Indiana University
- 12:00 – 12:15 **INVESTIGATING PHYSIOLOGICAL COSTS OF RESISTANCE TO MALARIA PARASITES IN BREEDING CONDITION MALE SONGBIRDS**
Katie M. Talbott
Graduate Student, Department of Biology, Indiana University
- 12:15 – 12:30 **CUMULATIVE EXPERIENCE INFLUENCES CONTEST INVESTMENT IN A SOCIAL FISH**
Macie D. Benincasa
Graduate Student, Department of Evolution, Ecology and Organismal Biology, The Ohio State University
- 12:30 – 12:45 **TRACING INTER-INDIVIDUAL VARIATION IN BEHAVIOR AND NEURAL GENE EXPRESSION OF AGGRESSIVE FEMALE BIRDS**
Liz Aguilar
Graduate Student, Department of Biology, Indiana University

LUNCH BREAK AND

CAREER PANEL: 1:00-2:00 PM

Delia Shelton, Assistant Professor of Biology, University of Miami
Jodie Jawor, Program Director, NSF; Affiliate Research Faculty, New Mexico State University
Jon Massey, Scientist, LanzaTech

Lunch will be provided for those who registered to attend the career panel.

- SESSION VII **COGNITION AND SPATIAL NAVIGATION**
- 2:15 – 2:30 **REPLAY OF INCIDENTALLY ENCODED EPISODIC MEMORIES IN THE RAT**
Cassandra L. Sheridan
Graduate Student, Department of Psychological and Brain Sciences, Indiana University
- 2:30 – 2:45 **DIFFERENCES AMONG FEMALE AND MALE *PHRYNUS MARGINEMACULATUS* (ARACHNIDA: AMBLYPYGI) IN THE USE OF SELF-DERIVED CHEMICAL CUES FOR SHELTER RECOGNITION**
Patrick E. Casto
Graduate Student, Department of Biology, Bowling Green State University
- 2:45 – 3:00 **WOLF SPIDER DECISION-MAKING BASED ON DISTANCE FROM A FOOD SOURCE**
Jenna L. Burns
Undergraduate Student, Department of Zoology, Kentucky Wesleyan College

3:00 – 3:15 **MICE EXHIBIT SIMILAR BEHAVIOR ORGANIZATION ACROSS DIFFERENT SCALES OF MOVEMENT**
Ericka A. Schaeffer
Graduate Student, Department of Psychology, Northern Illinois University

3:15 – 3:30 **MORPHOLOGICAL CHANGES PERSIST FOLLOWING MTBI-INDUCED EPISODIC MEMORY IMPAIRMENT IN RATS**
Gabriel Nah
Graduate Student, Program in Neuroscience, Indiana University

REFRESHMENT BREAK

3:45 – 4:45 **2023 EXEMPLAR AWARDEE AND PLENARY SPEAKER:**

IN SICKNESS AND IN HEALTH: COMPLEX EFFECTS OF SOCIAL BEHAVIOR ON INFECTIOUS DISEASE
Vanessa Ezenwa
Professor, Department of Ecology and Evolutionary Biology, Yale University

5:00 – 5:15 **AWARD PRESENTATIONS AND CLOSING REMARKS**
Undergraduate Poster Award
Hanna Kolodziejewski Fellowship
William J. Rowland Mentoring Award
Goodson Prize for Art in Science

CLOSING RECEPTION

Please join us this evening for a reception at the Convention Center.

5:15-6:45 PM

1st Floor Lobby, Monroe Convention Center

POSTER PRESENTATIONS

FRIDAY, MARCH 31ST, COOK AND ZEBENDON ROOMS, MONROE CONVENTION CENTER

Organized alphabetically by first author last name. Numbers indicate poster numbers. Abstracts are available on the conference website.

- | | |
|---|---|
| 1 ESTROGEN AND PROGESTERONE CONCENTRATIONS PREDICT GUT MICROBIOME COMPOSITION THROUGHOUT REPRODUCTIVE STATES IN FEMALE BABOONS | Barrios LA ¹ , Southworth CA ¹ , Dasari M ¹ , Altmann J ² , Alberts SC ^{3,4} , Barriero L ⁵ , Blekhman R ^{6,7} , Tung J ³ , Archie EA ¹
<i>¹Department of Biological Sciences, University of Notre Dame; ²Department of Ecology and Evolutionary Biology, Princeton University; ³Department of Biology and ⁴Department of Evolutionary Anthropology, Duke University; ⁵Department of Medicine, University of Chicago; ⁶Departments of Genetics, Cell Biology, and Development and ⁷Department of Ecology, Evolution, and Behavior, University of Minnesota</i> |
| 2 EFFECT OF MU-OPIOID RECEPTOR KNOCK-OUT ON FEAR CONDITIONING, EXTINCTION, AND MORPHINE-ANALGESIA | Beckett HT, Reichert AN, Dowell J, Radke AK, Quinn JJ
<i>Department of Psychology, Miami University</i> |
| 3 THE IMPACT OF AEROSOLIZED IRON OXIDE NANOPARTICLE EXPOSURE ON BEHAVIOR OF THE HOUSE SPARROW <i>PASSER DOMESTICUS</i> | Bergstrom J ¹ , Jankowski L ¹ , Ronald K ¹ , Gonzalez-Pech N ²
<i>¹Department of Biology and ²Department of Chemistry, Hope College</i> |
| 4 EFFECTS OF ACUTE EARLY LIFE STRESS AND CRH ₂ RECEPTOR ANTAGONISM ON FEAR ACQUISITION AND ANXIETY IN ADULT RATS | Brand K, Chappell L, Minshall B, Reichert A, Quinn J
<i>Department of Psychology, Miami University</i> |
| 5 FEMALE VOCALIZATIONS IN RESPONSE TO MALE AND FEMALE URINE | Brecht C, Dole M, Archer A
<i>Department of Biology, Hope College</i> |
| 6 ADRENAL STEROIDOGENESIS IN TERRITORIAL FEMALE TREE SWALLOWS | Buehler AE, Levy EJ, Aguilar EA, Rosvall KA
<i>Department of Biology and Center for the Integrative Study of Animal Behavior, Indiana University</i> |

- | | | |
|----|---|--|
| 7 | EFFECT OF TERRITORY PROXIMITY ON PERSONALITY AND DOMINANCE COST IN MALES OF THE CICHLID FISH <i>ASTATOTILAPIA BURTONI</i> | Buzinski ODK ¹ , Dolben E ^{1,2} , Dijkstra PD ^{1,3}
<i>¹Department of Biology, Central Michigan University;
²Department of Biology, University of Manchester;
³Neuroscience Program and Institute for Great Lakes Research, Central Michigan University</i> |
| 8 | STRANGER DANGER? THE SOCIAL ABILITIES OF PAINTED TURTLES | Byrne C, Reinke BA
<i>Department of Biology, Northeastern Illinois University</i> |
| 9 | STRIDES IN THE DARK: EFFECTS OF ARENA SIZE ON OPEN FIELD BEHAVIOR | Campbell N, Schaeffer E, Wallace D
<i>Department of Psychology, Northern Illinois University</i> |
| 10 | BEHAVIORAL RESPONSES TO CHRONIC AND ACUTE STRESSORS IN PRAIRIE VOLES | Chavez Y, Grippo AJ
<i>Department of Psychology, Northern Illinois University</i> |
| 11 | THE EFFECTS OF INFLAMMATION AND SOCIAL STRESS ON EMOTION IN AN ANIMAL MODEL | Crandall T, Akinbo O, Grippo A
<i>Department of Psychology, Northern Illinois University</i> |
| 12 | HOW DO FEMALES OF A MOUTHBROODING CICHLID FISH REGULATE THE METABOLIC COST OF REPRODUCTION? | Dijkstra PD
<i>Department of Biology, Central Michigan University</i> |
| 13 | SENSITIVITY TO SEX STEROIDS IN THE VISUAL SYSTEM IN RESPONSE TO SOCIAL COMPETITION | Empson TA ^{1,2} , Bentz AB ^{1,3} , Rosvall KA ¹
<i>¹Department of Biology and Center for the Integrative Study of Animal Behavior, Indiana University; ²Department of Ecology and Evolutionary Biology, University of Tennessee Knoxville; ³Department of Biology, University of Oklahoma</i> |
| 14 | THE ROLE OF THE PARAVENTRICULAR NUCLEUS OF THE THALAMUS IN THE EXPRESSION OF SAFETY LEARNING | Gogusoglu S, Buck AL, Reichert A, Quinn J
<i>Department of Psychology, Miami University</i> |
| 15 | BODY MASS AND BROOD SIZE INTERACT WITH THERMOREGULATORY MECHANISMS IN WILD NESTLING SONGBIRDS | Guardado EA ^{1,2} , Woodruff MJ ² , Tsueda SN ² , Rosvall KA ²
<i>¹Department of Biological Sciences, Purdue University; ²Center for the Integrative Study of Animal Behavior and Department of Biology, Indiana University</i> |

- | | | |
|----|--|---|
| 16 | LONG-TERM MELATONIN ADMINISTRATION INDUCES SEASONAL PHYSIOLOGICAL AND BEHAVIORAL SWITCHES IN FEMALE SIBERIAN HAMSTERS (<i>PHODOPUS SUNGORUS</i>) | Han Y ¹ , Lansing MX ¹ , Eggleston KG ² , Munley KM ¹ , Demas GE ¹
¹ <i>Department of Biology, Indiana University;</i>
² <i>Departments of Biology and Neuroscience, King University</i> |
| 17 | THE EFFECT OF SOCIAL STATUS ON TRANSCRIPTIONAL REGULATION AND OF OXIDATIVE STRESS IN THE BRAIN | Harvey AR ¹ , Fialkowski RJ ² , Bush BJ ³ , Wong RY ⁴ , Dijkstra PD ^{1,2,3}
¹ <i>Department of Biology,</i> ² <i>Neuroscience Program, and</i>
³ <i>Institute for Great Lakes Research, Central Michigan University;</i> ⁴ <i>Department of Biology, University of Nebraska</i> |
| 18 | EMBRYONIC LEARNING IN LAKE STURGEON (<i>ACIPENSER FULVESCENS</i>) UNDER WARMING CONDITIONS | Karasch B, Ward J
<i>Department of Biology, Ball State University</i> |
| 19 | DOES THE HOUSE SPARROW (<i>PASSER DOMESTICUS</i>) PREFER LOCATIONAL OR COLOR-BASED CUES WHEN EXHIBITING FORAGING BEHAVIOR? | Kenney M, Slayton S, Smith M, Sturgeon H, Ronald KL
<i>Department of Biology, Hope College</i> |
| 20 | THE INFLUENCE OF SOCIAL ISOLATION ON THE REGULATION OF VOCAL PERCEPTION BY SEROTONIN | Khurram I, Hurley L, Hutchens SED
<i>Department of Biology, Indiana University</i> |
| 21 | NMDA ANTAGONIST REVERSES BEHAVIORAL DEFICITS INDUCED BY MUSCARINIC ANTAGONIST | Klausnitzer TM, White IM
<i>Department of Psychology, Morehead State University</i> |
| 22 | REPLAY OF INCIDENTALLY ENCODED EPISODIC MEMORIES IN THE RAT | Knappenberger M ¹ , Sheridan C ² , Crystal JD ²
¹ <i>Department of Neuroscience, Ursinus College;</i>
² <i>Department of Psychological and Brain Sciences, Indiana University</i> |
| 23 | A COMPARISON OF ANTIPREDATORY RESPONSES TO VISUAL AND OLFACTORY STIMULI IN HOUSE SPARROWS | Lauraine AJ, Comer EC, Hawkins SA, Huff FA, Ronald KL
<i>Department of Biology, Hope College</i> |
| 24 | RED-WINGED BLACKBIRDS NESTING NEARER TO YELLOW WARBLER AND CONSPECIFIC NESTS EXPERIENCE LESS BROOD PARASITISM | Lawson SL ¹ , Enos JK ² , Gill SA ³ , Hauber ME ⁴
¹ <i>Carl R. Woese Institute for Genomic Biology and</i>
² <i>Illinois Natural History Survey, University of Illinois Urbana-Champaign;</i> ³ <i>Department of Biological Sciences, Western Michigan University;</i> ⁴ <i>Department of Evolution, Ecology, and Behavior, University of Illinois Urbana-Champaign</i> |

- | | | |
|----|---|--|
| 25 | ZEBRA FINCH LEARNING IN VARIABLE TEMPERATURE CONDITIONS | Lefeuve M, Lu C, Rutkowska J
<i>Institute of Environmental Sciences, Jagiellonian University</i> |
| 26 | IMPACTS OF PRE-GESTATIONAL SOCIAL ISOLATION ON MATERNAL FERTILITY AND OFFSPRING COGNITIVE FUNCTION | Lumley AL ¹ , Lindsey J ¹ , Giblin J ² , Provost T ¹ , Keesom SM ¹
¹ <i>Department of Biology, Utica University;</i>
² <i>Department of Biomedical Engineering, University of Southern California</i> |
| 27 | DIETARY DEFICIENCY IN POLYUNSATURATED FATTY ACIDS (PUFAS) RESULTS IN GENERAL MOTILITY DEFECTS IN <i>DROSOPHILA MELANOGASTER</i> LARVAE BUT NOT ADULTS | Masalu A, Dorsten J
<i>Department of Biology, Denison University</i> |
| 28 | TISSUE-SPECIFIC EXPRESSION OF DOPAMINE RECEPTORS DURING BREEDING IN BIPARENTAL BURYING BEETLES, <i>NICROPHORUS ORBICOLLIS</i> | Mediati GL, Thapa A, Panaitof SC
<i>Department of Chemical and Biological Sciences, Youngstown State University</i> |
| 29 | SERGEANT MAJOR (<i>ABUDEFDUF SAXATILIS</i>) SPAWNING AND NESTING BEHAVIOR IN THE 1724 GUADALUPE UNDERWATER ARCHAEOLOGICAL PRESERVE (GUAP) | Millar KW
<i>Center for Underwater Science, Indiana University</i> |
| 30 | IMPACTS OF BACKGROUND COLOR ON PHYSIOLOGICAL STRESS AND FITNESS IN AN AFRICAN CICHLID FISH | Mitchell H, Moore T, Dijkstra P
<i>Department of Biology, Central Michigan University</i> |
| 31 | SEX DIFFERENCES IN STRING PULLING WITH AN ACUTE STRESS RESPONSE DRUG: FEMALE RATS SHOW SENSITIVITY TO YOHIMBINE | Muscott S, Pianovski M, Wright C, Chavez Y, Akinbo O, Matuszewich L
<i>Department of Psychology, Northern Illinois University</i> |
| 32 | ACCEPT OR REJECT: DO MALE MICE ALTER SEXUAL BEHAVIOR IN RESPONSE TO FEMALE VOCALIZATIONS? | Navarro E, Hurley L
<i>Department of Biology, Indiana University</i> |
| 33 | SINGING IN THE HEAT: HOW MALE ZEBRA FINCH SONGS VARY WITH TEMPERATURE | Para L, Proffitt M, Derryberry E
<i>Department of Ecology and Evolutionary Biology, University of Tennessee Knoxville</i> |
| 34 | “TAP DANCING” IN <i>DENDROBATES TINCTORIUS</i> : AN INVESTIGATION INTO POSTERIOR TOE TAPPING AND FEEDING BEHAVIOR | Parrish T, Fischer EK
<i>Department of Evolution, Ecology, and Behavior, University of Illinois Urbana-Champaign</i> |

- 35 EFFECTS OF MICROPLASTICS AND ITS POTENTIAL AS A VECTOR OF 17 α -ETHINYLESTRADIOL (EE2) ON EARLY LIFE STAGE BEHAVIORS IN JUVENILE *PIMEPHALES PROMELAS* Persinger K, Ward J
Department of Biology, Ball State University
- 36 SSRI-ASSOCIATED SEXUAL AND ROMANTIC SIDE EFFECTS IN AMERICAN ADULTS: DIFFERENT PATTERNS AMONG DIFFERENT SEXES Piazza M^{1,2}, Gesselman AN^{1,3}, Garcia JR^{1,4}
¹*The Kinsey Institute and* ²*Department of Anthropology, Indiana University;* ³*School of Nursing, Indiana University–Purdue University Indianapolis;* ⁴*Department of Gender Studies, Indiana University*
- 37 DO PAIR-BONDING POISON FROGS PREFER THE CALLS OF THEIR MATES OVER THOSE OF STRANGERS? Podraza ME, Moss JB, Fischer EK
Department of Evolution, Ecology, and Behavior, University of Illinois Urbana-Champaign
- 38 MIGRATORY STRATEGY PREDICTS REPRODUCTIVE READINESS IN A WILD SONGBIRD: IMPLICATIONS FOR RESPONSES TO CLIMATE CHANGE Reed S¹, Jahn A^{1,2}, Sinkiewicz D³, Ketterson E^{1,2}
¹*Department of Biology,* ²*Environmental Resilience Institute and* ³*Center for the Integrative Study of Animal Behavior, Indiana University*
- 39 FORAGING JUVENILE WOLF SPIDER RESPONSE TO PREDATORY BIRD CALLS Rice A, Hanson M, Zombirt A, Ruble S, Watson K, Gibson J
Department of Zoology, Kentucky Wesleyan College
- 40 THE EFFECT OF PHYSICAL ENRICHMENT ON PREFERENCES AND SOCIAL BEHAVIORS IN MICE Rivera M, Brunner L, Hurley L
Department of Biology and Center for the Integrative Study of Animal Behavior, Indiana University
- 41 IMPACTS OF TESTOSTERONE AND *PLASMODIUM* PARASITE LOAD ON DARK-EYED JUNCO SPERM QUALITY Ross KV, Talbott KM, Ketterson ED
Department of Biology, Indiana University
- 42 SMELLING THE DIFFERENCE: USING STRING PULLING BEHAVIOR TO INVESTIGATE MOUSE (*MUS MUSCULUS*) ODOR ENCODING AND RETENTION Sampson H, Bogunia J, Wallace D
Department of Psychology, Northern Illinois University
- 43 SINGLE-TIME MELATONIN INJECTIONS MAY INCREASE AGGRESSIVENESS IN MALE SIBERIAN HAMSTERS *PHODOPUS SUNGORUS* Szwed SM¹, Han A¹, Eggleston KG², Demas GE¹
¹*Department of Biology, Indiana University;* ²*Departments of Biology and Neuroscience, King University*
- 44 THE EFFECTS OF EARLY-LIFE DIET AND SOCIAL ENVIRONMENT ON TESTOSTERONE AND IMMUNE FUNCTION: EXPERIMENTAL EVIDENCE FROM SPADEFOOT TOADS Thomas AM¹, Nesta DJ², Lagon SR², Ledón-Rettig CC²
¹*George Mason University;* ²*Department of Biology, Indiana University*

- 45 POSITIVE AND NEGATIVE INCENTIVE CONTRAST IN RATS: A NEW LOOK AT THE DIFFERENCES BETWEEN THE SEXES
Thompson K, Cromwell HC
Department of Cognitive and Neuropsychology, Bowling Green State University
- 46 HOW FAR DO AMERICAN ROBINS GO TO REJECT PARASITIC EGGS FROM THEIR NESTS? EXAMINING THE CAUSES AND CHARACTERISTICS OF EGG EJECTION BEHAVIOR IN A HOST OF THE BROWN-HEADED COWBIRD
Turner AM¹, Sluis VN¹, Williams EJ², Benson TJ³, Ward MP^{3,4}, Hauber ME^{1,3}
¹*Department of Evolution, Ecology, and Behavior, University of Illinois Urbana-Champaign;*
²*Department of Biology, Georgetown University;*
³*Illinois Natural History Survey, Prairie Research Institute and* ⁴*Department of Natural Resources and Environmental Sciences, University of Illinois Urbana-Champaign*
- 47 ANTHELMINTIC TREATMENT EFFECTS ON COCCIDIA SHEDDING IN THE DARK-EYED JUNCO (*JUNCO HYEMALIS*)
Tysver AM, Talbott KM, Wanamaker SM, Ketterson ED
Department of Biology, Indiana University
- 48 SOCIAL INFORMATION IN THE CONTACT CALLS OF COMMON VAMPIRE BATS
Vrtilek JK¹, Smith-Vidaurre G^{2,3}, Carter GG^{1,4}
¹*Department of Evolution, Ecology, and Organismal Biology, The Ohio State University;* ²*Rockefeller University;* ³*Department of Biological Sciences, University of Cincinnati;* ⁴*Smithsonian Tropical Research Institute, Panama*
- 49 USING BIOLOGGING DATA FROM TURTLES TO ASSESS REPEATABILITY AND CONSISTENCY IN PHYSIOLOGICAL BEHAVIORS
Waldrep C¹, Schaeffer P¹, Parlin A², Rypstra A³
¹*Department of Biology, Miami University;*
²*Department of Environmental Science and Forestry, State University of New York;* ³*Department of Biological Sciences, Miami University Hamilton*
- 50 A POTENTIAL ROLE FOR THE LATERAL LINE IN EMBRYONIC COMMUNICATION IN OVIPAROUS FISHES
Ward J, McDonald A
Department of Biology, Ball State University
- 51 NO STRINGS ATTACHED: INVESTIGATING THE EFFECTS OF RADIATION THERAPY ON MOUSE (*MUS MUSCULUS*) FINE MOTOR CONTROL
Wright C, Schaeffer E, Sampson H, Planck E, Yasui L, Wallace D
Department of Psychology, Northern Illinois University
- 52 THE EFFECT OF HEATWAVES ON THE TRADEOFF BETWEEN IMMUNITY AND AGGRESSION IN *GRYLLODES SIGILLATUS* MALE CRICKETS
Zhang Z, Ayala D, Murphy M
Department of Biology, Indiana University

PLENARY AND KEYNOTE SPEAKER BIOGRAPHIES

PLENARY SPEAKER

VANESSA EZENWA, Ph.D.
PROFESSOR, YALE UNIVERSITY



Dr. Vanessa Ezenwa completed her PhD in Ecology and Evolutionary Biology at Princeton University. She served as a National Research Council Fellow at the US Geological Survey before joining the faculty at the University of Montana in 2005. From 2010 to 2021, she held joint appointments in the Odum School of Ecology and Department of Infectious Diseases at the University of Georgia, where she was appointed a Georgia Athletic Association Professorship. She is now a Professor at Yale University, where her lab studies the ecology and evolution of host-parasite interactions. Using wild ungulates as a study system, her work combines field, lab, and theoretical approaches to understand how infections shape the behavior, physiology, and ecology of their animal hosts. Earlier this year, she was named an AAAS Fellow.

KEYNOTE SPEAKER

JUSTIN WOOD, Ph.D.
ASSOCIATE PROFESSOR, INDIANA UNIVERSITY - BLOOMINGTON



Dr. Justin Wood is an Associate Professor of Informatics at Indiana University Bloomington. He received his PhD in Psychology from Harvard University in 2008. Prior to joining IU, he was an Assistant and Associate Professor of Psychology at the University of Southern California from 2008 to 2019. His research uses artificial intelligence, virtual reality, and controlled rearing to study animal intelligence and how early life experience influences perception and cognition. He has received funding from NSF CAREER, Facebook, and the James S. McDonnell Foundation.

ACKNOWLEDGEMENTS

CISAB ADMINISTRATION

Program Director: Dr. Cara L. Wellman

Program Assistant: Jessica Smith

Laboratory Director: David Sinkiewicz

Office Assistant: Charli Taylor

CONFERENCE ORGANIZERS

Program Committee

Megan Freiler (Chair)
Atalanta Ritter
Susan Reed
Lindsay Stolting
Dante Nesta
Ellie Shell

Promotions Committee

Liz Aguilar (Chair)
Ellie Shell
Sierra McAllister

Audio Visual Committee

Liz Aguilar (Chair)
Amanda Han
Emily Levy

Socializing Committee

Amanda Han
Beth Morrison
Katie Talbott

Poster Session Committee

Lindsay Stolting (Co-Chair)
Susan Reed (Co-Chair)
Megan Freiler
Undergraduate Volunteers

Undergraduate Poster Judges

Amanda Han
Susan Reed
Lauren Brunner
Ellie Shell
Dante Nesta
Lindsay Stolting

Registration Table Staff

Charli Taylor (Chair)
Jessica Smith

Social Media Coordinators

Liz Aguilar (Chair)
Lauren Brunner
Amanda Han
Atalanta Ritter

Program Cover Artist

Michelle Benavidez

FUNDING SOURCES

Indiana University Office of the Bicentennial

Indiana University College of Arts and Sciences

The Hanna Kolodziejski Fellowship Fund

The William J. Rowland Mentorship Award Fund

Indiana University Department of Biology

Indiana University Department of Psychological and Brain Sciences



Program in Animal Behavior

Center for the Integrative Study of Animal Behavior

Indiana University Bloomington

**409 North Park Avenue
Bloomington, IN 47405**

**(812) 855-9663
abeh@indiana.edu
animalbehavior.indiana.edu**